



ARTCOURT Gallery

Yagi Art Management, Inc.

OAP ARTCOURT 1F 1-8-5 Tenmabashi Kita-ku Osaka 5300042 JAPAN

Kaoru Matsumoto's "Cycle-90° Air Stream" installed at Iwatani R&D Center



"Cycle-90° Air Stream" installed in the lobby of Iwatani R&D Center
Photograph: Yoshihiro Asada / Vibra photo

We are excited to announce that the sculptor Kaoru Matsumoto's latest, "Cycle-90° Air Stream" has been installed in the lobby of Iwatani R&D Center (Amagasaki, Hyogo Prefecture, completed in May, 2013). The sculpture measures 4 m or 13' in diameter and 6.3 m or 20.5' in height. It is a large scale stainless steel/titanium kinetic sculpture, moved by the flow of air. Matsumoto's consideration on the winds blowing into Amagasaki and the air flowing into the exhibition space is what shaped this sculpture. The installation is notable as a collaboration with architecture. The exhibition space offers a beauty that one would expect to see at a museum.

【Project Outline】

Artist: Kaoru Matsumoto

Title: Cycle-90° Air Stream

Year: 2013

Material: Stainless steel, titanium

Dimensions: H 635 × W 400 × D 400 cm
(H 20.5' × W 13' × D 13')

Location: Iwatani R&D Center 1F Lobby

Coordinated by ARTCOURT Gallery

【Outline of the Iwatani R&D Center】

Location: 3-3-13 Tsugiyu, Amagasaki, Hyogo Prefecture

Site Area: 7,420m² (Approx. 80,000 sqft)

Total Floor Area: Approx. 12,000m² (Approx. 130,000 sqft)

Main Buildings: Main structure made up of a reception building, large experiment building and research building (seven story), and a general administrative building.

A hydrogen station for electric cars is planned to open in 2014.

Inquiry: Iwatani Corporation Osaka HQ, Public Relations
Ninomiya (+81 6 7637 3468)

*Please contact Miwa Ohba at ARTCOURT Gallery for any inquiries including photographic materials.

OAP Art Court 1F, 1-8-5 Tenmabashi, Kita-ku, Osaka 530-0042 | info@artcourtgallery.com | T: (+81) 6-6354-5444 | F: (+81) 6-6354-5449 | artcourtgallery.com

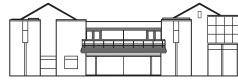

ARTCOURT Gallery

Yagi Art Management, Inc.

OAP ARTCOURT 1F 1-8-5 Tenmabashi Kita-ku Osaka 5300042 JAPAN

Kaoru Matsumoto's "Cycle-90° Air Stream" installed at Iwatani R&D Center

We are excited to announce that the sculptor Kaoru Matsumoto's latest, "Cycle-90° Air Stream" has been installed in the lobby of Iwatani R&D Center (Amagasaki, Hyogo Prefecture, completed in May, 2013). The sculpture measures 4 m or 13' in diameter and 6.3 m or 20.5' in height. It is a large scale stainless steel/titanium kinetic sculpture, moved by the flow of air. Matsumoto's consideration on the winds blowing into Amagasaki and the air flowing into the exhibition space is what shaped this sculpture. The installation is notable as a collaboration with architecture. The exhibition space offers a beauty that one would expect to see at a museum.

Challenging the endless possibilities that gas possess, Iwatani Corporation has built an R&D center in Amagasaki, Hyogo Prefecture, as its technological base. The new center is furnished with state of the art equipment, including the most advanced liquefied hydrogen research lab in the private sector. This R&D center include facilities to conduct joint researches with clients and manufacturing partners, as well as a showroom for Iwatani's own products. It is a multifunctional open research complex. The sculptor Kaoru Matsumoto's site-specific piece, "Cycle-90° Air Stream," is installed in the lobby of this research center as a mediator to stimulate imagination and energy for both the researchers and visitors.

Matsumoto's sculpture is kinetic. He utilizes air flows to give motion to his creation. Air is invisible to our eyes yet something we feel through our five senses everyday. Matsumoto made air visible in his "Cycle-90° Air Stream" through its movement. It moves effortlessly like clouds move in the sky.

In the lobby of Iwatani R&D Center, a glass cylinder is dissecting the open entry hall. This cylinder, bringing outdoor directly into indoor, is the display case for "Cycle-90 Air Stream." Two wings that are sticking out towards the sky catch the winds like a propeller and transfer the energy to move the main body of sculpture around the axis. This movement then makes two circular shapes to slide along their axis. Winds are the only contributor to generate the movement of the sculpture.

This installation was made possible by the seamless collaboration between the architects and artist with careful calculation of the winds. It is highly unusual to reserve space for outdoor sculpture within a building. This installation allows the best possible display for the sculpture. As if a living thing, the ever-moving "Cycle-90° Air Stream" quietly creates a rich and healthy backdrop for those who enter the building.

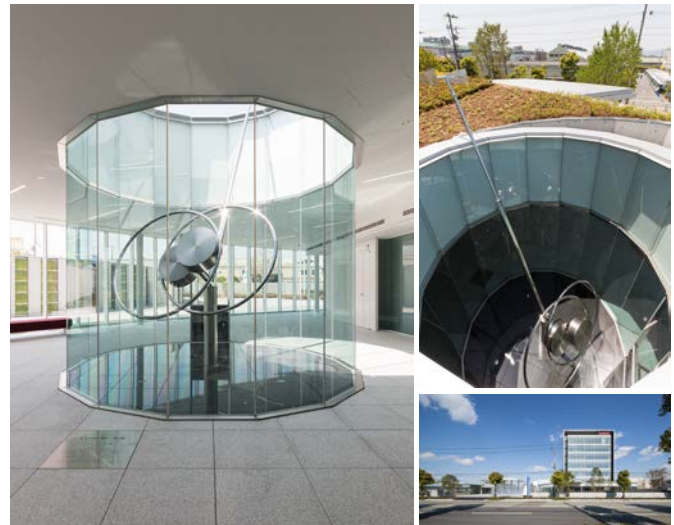

"Cycle-90° Air Stream" installed in the lobby of Iwatani R&D Center (left and top right) Iwatani R&D Center exterior (bottom right) Photograph: Yoshihiro Asada / Vibra photo

【Profile: Kaoru Matsumoto】

Born in Hyogo in 1952. His artistic career begins in the 70s. He works with metal, primarily stainless steel, in geometric shapes and creates large scale kinetic sculptures, which moves by winds or motor driven. Many of his works are public art. His works have been installed on university campuses and public spaces in western Japan, Tokyo, Hokkaido, and Taiwan, as well as several museums in Japan. Recent installations include Industrial Technology Research Institute (ITRI, Taiwan. 2013) and Abeno Harukas (Osaka), which is scheduled to open in 2014.

【Artist's statement on "Cycle-90° Air Stream"】

This work uses "the movement of [air]" to create motion. [There are several gases mixed in what we call air; nitrogen, oxygen, carbon dioxide, argon, helium, and hydrogen. These gases, moving constantly, create the flow of air.] We usually experience the invisible flow of air as the sound of rustling branches in a forest, floating clouds and ripples in water. It is through our five senses that these reach our very souls. Since ancient times, the wind has moved sandy soil, formed climates, controlled population movements and guided people in the creation of cultures. This work gives concrete visual expression to that invisible presence, sometimes passive, sometimes moving depending on the wind, making it changeable and highly unpredictable. It is my hope that this will allow visitors to [this laboratory] and those who work there to feel first-hand the power of the wind, to focus on the movement of nature and interpret these messages from the Earth. Only then will this become a place where imagination takes flight.

— Kaoru Matsumoto, 2013

*Please contact Miwa Ohba at ARTCOURT Gallery for any inquiries including photographic materials.